

Laying additional runs with a seam:

Laying textile covering with a seam



• Before laying, cut the seam according to the manufacturer's instructions. Place a steel plate underneath when making a double cut (never cut through the Sigan 1).

- The seam of the floor covering must not lie on the Sigan 2 joint.
- Lay the carpet run precisely at the seam.
- Fold back half of the textile covering (can also be taken back from the seam).
- Pull off the protective paper at a flat angle and form a flap.
- Lay and rub in the first run, and then lay the second run bit by bit precisely along the seam, and rub in.
- Rub/roll in well in the transverse direction.

Attention: Never use toggle stretchers or seam tacks!

Laying elastic floor coverings with a seam



• Before laying, cut the seam according to the manufacturer's instructions. Place a steel plate underneath when making a double cut (never cut through the Sigan 1).

- The seam of the floor covering must not lie on the Sigan 2 joint.
- Lay the floor covering precisely at the seam.
- Without changing its position, fold back half of the floor covering.
- Pull off the protective paper at a flat angle and form a flap.
- Lay and rub in the first run, and then push in the second run bit by bit up to the seam at an angle, and lay to match precisely.
- Rub/roll in well in the transverse direction.

Technical Data:

Special film carrier, micro-perforated, double-sided adhesive, different special coatings, residue-free removal, protective paper covering on one side, patented

Special acrylic adhesive, clean indoor air

Roll width 75 cm, roll length 25 m

Suitable for project work, no area size limits

Resistant to cleaning systems, suitable for spray-extraction cleaning

Plasticiser resistant

Suitable for castor-wheels, pallet-trucks, fork-lift trucks*

Suitable for underfloor heating systems*

*The new floor covering and the substrate must also be suitable.

Ingredients: acrylate copolymers, wetting and de-foaming agents, plastic film, paper

Important tips:

Store in the standing position in a dry and cool place, away from direct sunlight. Rewrap opened rolls in protective paper.

You can obtain more information on:

www.uzin.com or by calling +49 (0) 731 4097-0

Special instructions:

Welding / sealing of seams and joints



• Joints and seam locations of homogenous and heterogeneous PVC/CV coverings in rolls or tiles (with the exception of design coverings in planks or tiles) must be thermally or chemically welded together.

- The information provided by the floor covering manufacturer must be observed when carrying out the welding/joining.
- The welding/joining can be carried out immediately after the gluing.

Pushing in the textile covering («Water trick»)



When laying the seam, when cutting to shape and when pushing the textile covering under radiators or around columns, etc., proceed as follows:

- Pull the protective paper from the Sigan 1
- Dampen the Sigan 1 at the desired position using a sponge.
- Push the textile covering into the desired position (aqua-planing effect).
- When the water evaporates, the Sigan 1 will recover its full adhesive strength.
- Rub in the textile covering again.

Safety at work and environmental protection:

The product requires no particular measures to ensure safety at work. For reasons of workplace hygiene, we would recommend that you should not eat, drink or smoke while applying this product. Keep out of the reach of children.

Disposal:

Empty shells and the cardboard packaging can be recycled. Material remnants can be disposed of as household waste.

Guarantee:

UZIN provides a 5-year warranty on all the characteristics guaranteed in the application Instructions. Sigan correspond to VOB Part C, Pt. 2.7 Adhesives: «They form a fixed and durable connection, and cause no impairment to either the floor covering or the sub-surface, and produce no pollution through odour after fitting».

• Follow the generally accepted rules of the trade and the technology for laying floor coverings according to the valid national standards EN

This guarantee will not apply if:

- Sigan 1 products are used in outside areas, operating theatres and in vehicle construction.
- unusual influences, and in particular those of a chemical or mechanical nature, affect the product.
- sub-surface unevenness occurs (insufficient stability of the sub-surface).
- in case of any utilisation or processing that deviates from the laying instructions (never use Sigan 1 on stairs or walls).
- PVC/CV runs or tiles are not thermally or chemically welded/joined, and joints / seams arise for this reason.
- discoloration arises from chemical reactions between the floor covering and the sub-surface.
- if joints are formed or warping occurs due to dimensional changes of the floor covering.
- the floor covering was laid stretched and under tension.
- dampness affects the Sigan 1.
- laying is carried out at temperatures below 15 °C (at the floor!).
- Sigan 1 is used in areas with increased air humidity and/or thermal loadings (e.g. conservatories).
- no adhesive trials are carried out.

Marked with the "Blue Angel" to indicate low-emission floor covering adhesives and other installation materials according to RAL UZ 113. Environmentally-friendly because the emission level is very low.

PRODUCT DATA SHEET

High-performance adhesive (special film carrier)

Sigan 1



Fast adhesion of new coverings onto levelling compounds and chipboard

Product Properties / Benefits:

- ▶ Quick and easy installation
- ▶ No trapped air bubbles thanks to micro-perforation and ventilation channels
- ▶ The covering is immediately ready to accept traffic and loading
- ▶ Can be bonded/used immediately
- ▶ Later removal leaves no residue
- ▶ „Blue Angel" according to RAL UZ113
- ▶ EMICODE EC1 PLUS / Very low emissions PLUS

Applications:

▶ Suitable floor coverings:

- Elastic floor coverings (runners & tiles):
 - PVC, CV, PVC design coverings (EN 649)
- Joints & seams in elastic floor coverings must be welded. Refer to «Special Hints» for details!

b) Textile coverings:

- Fleece backing
- Synthetic action backs (SDR)
- Textile action backs (TR), (exception: Texback)
- Latex foam backs
- Carpet tiles with fleece, PVC or bitumen backs
- Kugelgarn®
- FINETT 7 (100 % PP needle punch)

▶ Suitable sub-surfaces:

- > For use only Planus primed floors.
- Cement composition floor CT (filled, sanded)
 - Anhydrite tile composition floor CAF (sanded)
 - Anhydrite mortar CA (sanded)
 - Magnesia flooring MA (sanded)
 - Filling compounds containing cement (sanded)
 - Calcium sulphate filling compounds (sanded, completely dried through as described in the manufacturer's instructions)
 - Wooden floors (untreated), chipboard V100, Plywood/ MDF tiles (fill edges, joints with a stable, cement-based filler), two coats of Planus may be necessary
 - Aluminium and metal (untreated)



for new PVC, CV coverings, textile coverings

ON filled floors, calcium sulphate coatings, chipboard

▶ Non-guaranteed floor coverings:

- Oriental carpets, carpet bridges, runners, fitted carpets
- Carpet runs with PVC backs (e.g. dirt traps)
- Linoleum, PO coverings
- PVC design coverings from Armstrong DLW
- Carpet with adhesive-repellent coatings on the back (e.g., PUR)
- Woven
- Coconut, sisal, cork, real hair
- Texback from Vorwerk
- Needle punch
- Aluminium and metal floor coverings
- Vinyl-polyester floor coverings or woven vinyl

▶ Non-guaranteed sub-surfaces:

- Elastic floor coverings (PVC, CV, linoleum) → Sigan 2
- PVC coated cork coverings → Sigan 2
- PU and epoxy resin coats → Sigan 2
- Polyolefin coverings (PO) → Sigan 2
- Parquet/laminate → Sigan 3
- Ceramic tiles, smooth → Sigan 3
- Ceramic tiling/Terrazzo → Sigan 3
- Sealed cork coverings → Sigan 3
- Textile floor coverings → Sigaway
- Marble and natural stone floors (discolouration)
- Surfaces containing bitumen and cast asphalt
- Profiled stone flags (embossing/grouting pattern)
- Plaster fibreboard, gypsum plasterboard, unfilled
- Insulation linings

APPLICATION INSTRUCTIONS

Preparing the sub-surface:

- ▶ The sub-surface must be permanently dry, hard, firm, flat and able to be walked on, be free from grease, dust and silicone.
- ▶ Carry out repairs or filling work to the sub-surface using a cement-based filling compound (not a dispersion filling compound).
- ▶ Prime repaired/filled areas with a pre-coating of Planus and allow to dry.
- ▶ Apply the special Planus undercoat. When applying Planus, the following must always be carried out:
 - Thoroughly vacuum clean the sub-surface with an industrial vacuum cleaner before starting
 - Shake the Planus container well before use
 - Empty the undiluted liquid into a clean bucket
 - Apply evenly at 70 – max. 100 g/m² using a foam roller (or a nylon plush roller for wooden materials), applying cross-wise.
 - Avoid the formation of puddles/spots and grooves
 - Allow to dry for at least 2 hours with good ventilation. The Planus must be completely dried out. The drying time depends on the ventilation, the room climate and the sub-surface. On sub-surfaces containing plaster or bound with calcium sulphate, drying can take up to 4 hours.
 - Do not acclimatize the floor covering on the Planus.
- ▶ If standing wood fibres form a rough surface following the application of Planus to wooden materials, a new coat of Planus should be applied using a nylon plush roller once the previous coat has dried.
- ▶ After drying out, the surface must show a thin film (slight shine).
- ▶ Perfect adhesion with Sigan 1 and re-lifting without residue is only guaranteed with Planus. Do not use any other undercoat.
- ▶ Trial gluing: Rub Sigan 1 well into the primed sub-surface. If the Sigan 1 separates from the sub-surface, apply another coat of Planus.
- ▶ Floor coverings according to DIN EN 649 and DIN EN 1903 are suitable. These standards allow for dimensional tolerances in floor coverings, the forming of joints therefore cannot be excluded. In order to minimize a possible forming of joints, you should allow the floor covering and the Sigan 1 (48 h) to acclimatize sufficiently according to the room in which they are to be laid.



requires Planus
Special Precoat

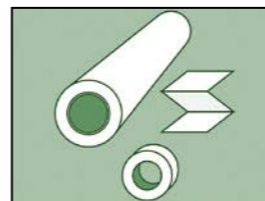

Contents:

- 20 m²
- 1 roll Sigan 1; 75 cm x 25 m
- 1 roll Sigan1tape; 5 cm x 25 m

Laying the 50 mm Sigan1tape:

- ▶ Apply the Sigan1tape along the walls and doors a) to even out uneven walls, b) for increased adhesion in the edge areas, c) for gluing areas that are difficult to access.
 - ▶ Do not pull off the protective paper yet.
- Attention: Only use the enclosed Sigan1tape (can be removed without residue).
- ▶ Do not overlap the Sigan1tape, but mount edge to edge, or cut back to a butt-joint where overlapping.

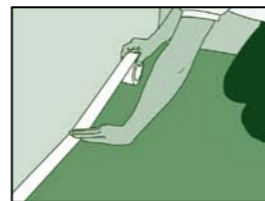

Laying the Sigan 1 750 mm dry adhesive:

- ▶ Unroll the Sigan 1 in the running or working direction of the new floor covering - with a slight pressure on the roll – preferably roll out overlapping, rub in well and then cut back to the joint using a hooked knife, or roll out edge to edge directly (max. 3 mm gap allowed, no overlapping). Do not damage the sub-surface.
- Attention: Never stick the strongly adhesive side (covered with protective paper) to the sub-surface.
- ▶ Ventilation channels can show through with elastic coverings.
 - ▶ Sigan 1 can be overlapped on Sigan1tape, but must then be cut back to fit edge-to-edge.
 - ▶ Only roll out the same amount of unused Sigan 1 as the amount of floor covering that will be laid on the same day.
 - ▶ Lay the last run of Sigan 1 starting from the wall. Cut back the resulting overlap to fit edge-to-edge using a hooked knife. Do not damage the subsurface while doing this.
 - ▶ Wrap up any remaining rolls of Sigan 1 in protective paper (edge protection and protection against dust).

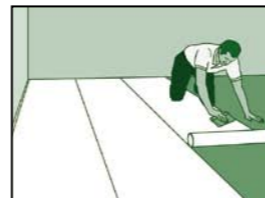

Preparatory work for horizontal conducting floor coverings:

- ▶ Pull back the Sigan 1 protective paper by approx. 40 cm across the direction of the run or the seam of the new floor covering. Do not fold!
- ▶ With a distance from the wall of approx. 10 cm over the complete width of the room, glue 1 run of self-adhesive copper tape onto the exposed Sigan 1. The non-adhesive side faces upwards.
- ▶ Lay a terminal lug (approx. 1 m) at the height of the earth connection to the earth, overlapping the previously laid copper tape. The connection must be carried out by a qualified electrician!
- ▶ Lay the protective paper back onto the Sigan 1 and press it down.
- ▶ Carry out the same procedure on the opposite side (2 connections per room).

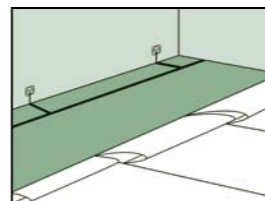

Caution: Only use coverings with horizontal conducting back coatings.

The copper tape may show through the floor covering.

Laying the floor covering:

- ▶ Lay out the floor covering and fit approximately.
- ▶ Fold back half of the floor covering run in the running or working direction.



- ▶ Pull the protective paper from the Sigan1tape.
- ▶ Pull the protective paper away from the Sigan 1 flat and straight up to the folded-back floor covering.
- ▶ Cut off the pulled-away protective paper leaving a remainder of 10 cm. Fold the rest under the folded-back floor covering (forming a flap).
- ▶ Stack the protective paper and roll it together (minimises the volume of the waste).

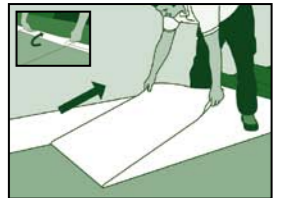

Textile coverings:

- ▶ Lay the first half of the textile covering free of tension and undulations, and rub in.
- ▶ Fold back the second half of the textile covering and pull off the rest of the protective paper with the help of the flap.
- ▶ Lay the textile covering, rub in and cut to fit at the edge.



Elastic floor coverings:

- ▶ Bit by bit, push in the first half of the floor covering (avoiding air bubbles) and rub/roll in in the transverse direction.
- ▶ Fold back the second half of the floor covering and pull off the remaining protective paper with the aid of the flap.
- ▶ Slowly push in the floor covering, rub in/roll in and cut to match at the edges.



PVC designer coverings and PVC tiles:

- ▶ Measure out the room, and divide into planks/tiles. Mark the starting point of the first plank/tile row on the protective paper using a suitable pen/marker.
- ▶ Place a steel rail along the start points, and align it.
- ▶ Pull off the protective paper from the Sigan 1 flat and straight up to the steel rail.
- ▶ Pull off the protective paper diagonally upwards along the steel rail. The straight line that is thereby obtained serves as a reference line for the first plank/tile row.
- ▶ Stack the protective paper and roll it together (to minimise the volume of waste).

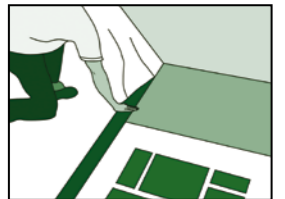

- ▶ Lay the planks/tiles along the reference line free of any tension and stresses, and press down firmly by hand.
- ▶ Continually pull back the protective paper flat and straight. Lay the floor covering as described. If there are any interruptions in the laying process, the protective paper can be reapplied as a protection for the Sigan 1.
- ▶ After laying, rub down/roll the whole area well crosswise.



Sigan is unique: Removing floor coverings without residue – and without damaging the sub-surface.

- ▶ First cut the floor covering into strips (approx. 25 –50 cm) using a hooked knife. Do not damage the sub-surface!
- ▶ Separate the Sigan1tape from the sub-surface, starting from a corner.
- ▶ Pull away the floor covering **together** with the Sigan 3 at a **flat angle**, and you're finished!

No adhesive residues will remain on the sub-surface when using Sigan 1 together with Planus. As a rule, the Sigan 1 can no longer be removed from the floor covering – but can be disposed of with the floor covering without any problem.

- ▶ Before any further laying with Sigan 1, the sub-surface must first be vacuum cleaned. Apply the special Planus pre-coat as required, and allow to dry completely. Then lay the new floor covering with Sigan 1.

